

Show Me

CABLES

USB-APSA1 & USB-APSA3

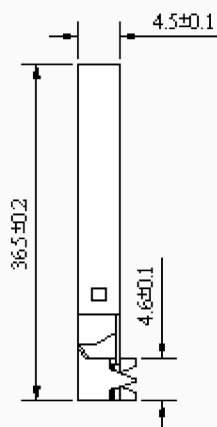
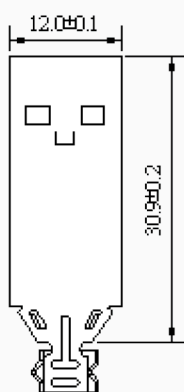
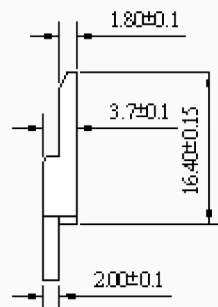
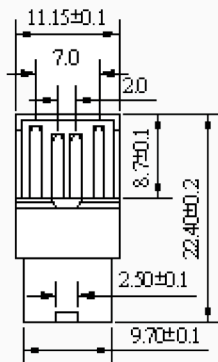

ELECTRICAL CHARACTERISTICS:

CONTACT CURRENT RATING: 1 AMPERES.
DIELECTRIC WITHSTANDING VOLTAGE: AC 500V R.M.S
INSULATION RESISTANCE: 500 MEGOHMS MINIMUM AT DC 500V.
CONTACT RESISTANCE: 30 MILLIOHMS MAXIMUM.
OPERATING TEMPERATURE: -55°C TO +105°C.

MECHANICAL CHARACTERISTICS:

CONTACT INSERTION FORCE: 6.0 KG MAXIMUM.
CONTACT SEPARATION FORCE: 1.0 KG MINIMUM.

MATERIALS:

CONTACT: BRASS.
INSULATOR: P.B.T. UL 94-V0 RATED.
SHELL: COLD ROLLED STEEL.

FINISHES:

CONTACTS: GOLD FLASHED A1=1U", A3=3U"
SHELL: NICKEL, TIN OR GOLD PLATED.