

6

5

4

3

2

1

REVISION

ZONE	REV	DESCRIPTION	DATE	CHANGED BY	APPROVED
	A	INITIAL RELEASE	11/07/2024	DMAY	DGUTTADAURO

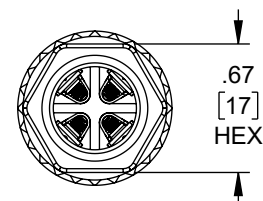
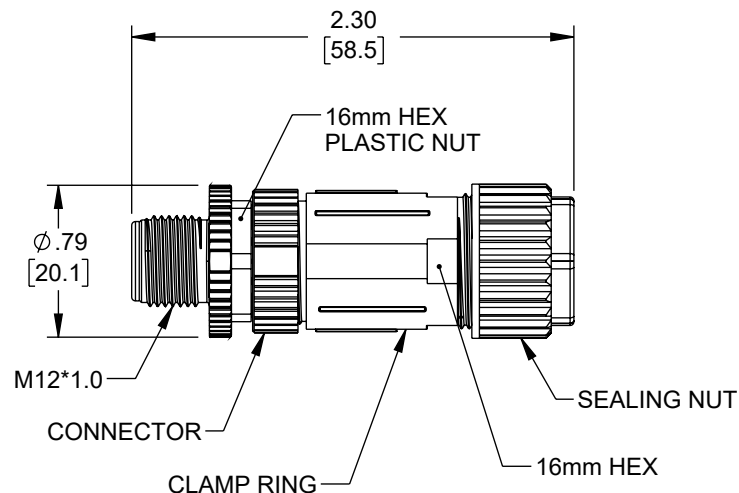
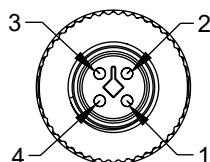

NOTES:

1. **QC** IMPORTANT DIMENSION.
2. WATERPROOF RATE: IP67, MATED
3. CONNECTOR:
 1. HOUSING: THERMOPLASTIC, BLACK
 2. PIN: COPPER ALLOY, GOLD PLATED
 3. EXTENSION NUT: THERMOPLASTIC, BLACK
 4. O-RING: RUBBER, GRAY
5. NUT: THERMOPLASTIC, BLACK
4. CLAMP RING: THERMOPLASTIC, BLACK
5. SEALING NUT: THERMOPLASTIC, BLACK
6. SEAL: RUBBER, GRAY, OD: $\phi 8\text{mm} \sim \phi 10\text{mm}$
7. ONE SET UNASSEMBLED IN ONE PE BAG
8. TEMPERATURE RANGE: -40°C TO $+105^{\circ}\text{C}$
9. OPERATING VOLTAGE: 60V
10. NOMINAL CURRENT: 12A

REGULATORY COMPLIANCE:
EU RoHS DIRECTIVE (MOST RECENT RELEASED VERSION).

THE INFORMATION CONTAINED IN THIS DRAWING IS THE SOLE PROPERTY OF INFINITE ELECTRONICS, INC. ANY REPRODUCTION IN PART OR WHOLE WITHOUT THE WRITTEN PERMISSION OF INFINITE ELECTRONICS, INC. IS PROHIBITED. THESE COMMODITIES, TECHNOLOGY OR SOFTWARE WERE EXPORTED FROM THE UNITED STATES IN ACCORDANCE WITH THE EXPORT ADMINISTRATION REGULATIONS. DIVERSION CONTRARY TO U.S. LAW PROHIBITED.

6

5

4

3

2

1

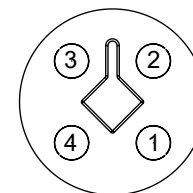

4P

PIN ASSIGNMENTS
FRONT VIEW

UNLESS OTHERWISE SPECIFIED
LEADING DIMENSIONS ARE INCHES
DIMENSIONS IN [] ARE MILLIMETERS

TOLERANCES:
X = ± 2 [5] FRACTIONS
.XX = ± 0.02 [0.5] $\pm 1/32$
.XXX = ± 0.005 [0.13] ANGLES $\pm 1^{\circ}$

CABLE LENGTH TOLERANCES:
 ≤ 12 [305] = ± 1 [25] / -0
 >12 [305] ≤ 60 [1524] = ± 2 [51] / -0
 >60 [1524] ≤ 120 [3048] = ± 4 [102] / -0
 >120 [3048] ≤ 300 [7620] = ± 6 [152] / -0
 >300 [7620] = $\pm 5\%$ / -0

ALL DIMENSIONS ARE FOR REFERENCE ONLY
AND SUBJECT TO CHANGE WITHOUT NOTICE.
UN-DIMENSIONED/NON-CRITICAL FEATURES
MAY VARY IN SIZE AND LOCATION
COLORS MAY VARY

Show Me
CABLES

an INFINIT[®] brand

Website: www.ShowMeCables.com
Phone: 1.888.519.9505

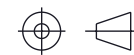

INTERPRET ALL DIMENSIONS AND
TOLERANCES PER ASME Y14.5

SCALE	SHEET
NONE	1 OF 1

DESCRIPTION
M12 DC POWER 4 PIN T-CODE MALE FIELD TERMINATION
CONNECTOR, IP67, PLASTIC NUT, FITS 16-20AWG AND 8-10mm
CABLE, 60V, 12A, SCREW-IN, BLACK

SIZE	CAGE CODE	DRAWN BY	ITEM NO.	REV
A	3SVT8	DMAY	M12P4TM-FT	A